

1.1 Remove allen head screws from both sides of case with allen key provided



1.2 Open up top lid of case to expose internal roller system



1.3 Remove narrow plastic strip from internal roller system

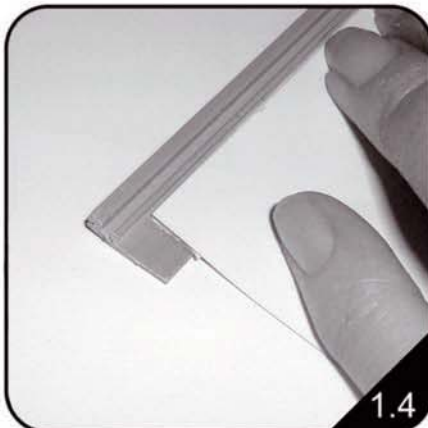

1.4 Remove paper strip to reveal adhesive tape. Stick the bottom of the graphic to the narrow plastic strip. Repeat for top of graphic to wide plastic strip provided.

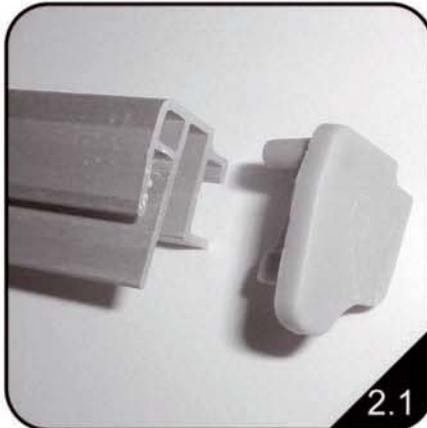

2.1 Remove end cap from top aluminium rail

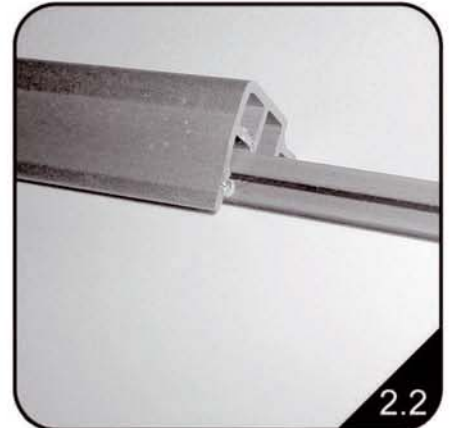

2.2 Insert wide plastic strip into top aluminium rail and replace end cap



2.3 Insert narrow plastic strip into internal roller

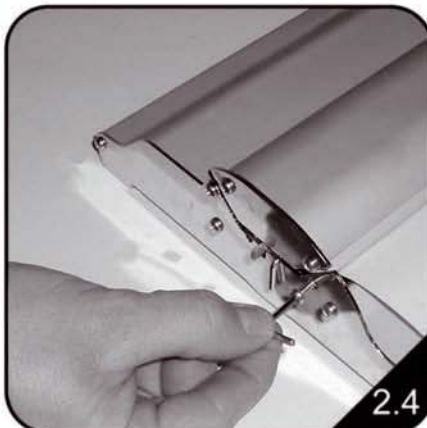

2.4 Close top lid to case and re-screw allen head screws in place



2.5 While holding graphic securely, remove holding pin from left side of the case. The tensioning system is now engaged.





Guide the graphic material slowly into the case



Pull Up top rail and graphic material



Insert top of bungee pole into the top aluminium rail



Make system level with adjustment screw under case